

Sheave Bearings
Series 5000

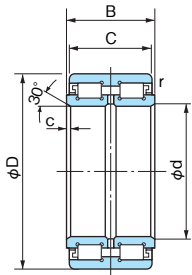

Shield type (E50)

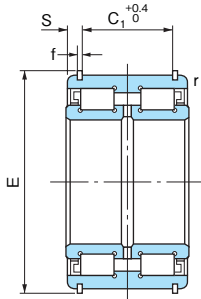

Shield type (E50...NR)
with snap rings

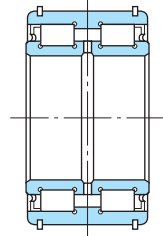

Rubber seal type (E50...NRNT)
with snap rings

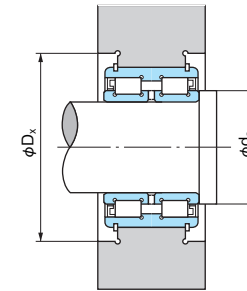

1N=0.102kgf

| Boundary dimensions (mm) | | | | | | | | | | Bearing No. | | | Basic load rating | | Limiting speed (min ⁻¹) Grease lubrication | Abutment and fillet dimensions (mm) | | Mass (kg) |
|--------------------------|-----|-----|-----|------------|-----|-------|----------------|------|-----|--------------------------------------|---------------------------------|-------------------------------------|-------------------|---------|---|--|-------------------------|-----------|
| d | D | B | C | r (min) | c | E | C ₁ | S | f | Without snap ring with shields | With snap rings with shields | With snap rings and rubber seals | Cr (N) | Cor (N) | | d _a (min) | D _x (min) | |
| 40 | 68 | 38 | 37 | 0.6 | 1.5 | 71.8 | 28 | 4.5 | 2 | E5008 | E5008NR | E5008NRNT | 79000 | 125000 | 46 | 80 | 0.57 | |
| 45 | 75 | 40 | 39 | 0.6 | 1.5 | 78.8 | 30 | 4.5 | 2 | E5009 | E5009NR | E5009NRNT | 95000 | 144000 | 51 | 87 | 0.71 | |
| 50 | 80 | 40 | 39 | 0.6 | 1.5 | 83.8 | 30 | 4.5 | 2 | E5010 | E5010NR | E5010NRNT | 99500 | 158000 | 56 | 92 | 0.77 | |
| 55 | 90 | 46 | 45 | 0.6 | 2 | 94.8 | 34 | 5.5 | 2.5 | E5011 | E5011NR | E5011NRNT | 117000 | 193000 | 63 | 104 | 1.18 | |
| 60 | 95 | 46 | 45 | 0.6 | 2 | 99.8 | 34 | 5.5 | 2.5 | E5012 | E5012NR | E5012NRNT | 123000 | 208000 | 68 | 109 | 1.26 | |
| 65 | 100 | 46 | 45 | 0.6 | 2 | 104.8 | 34 | 5.5 | 2.5 | E5013 | E5013NR | E5013NRNT | 128000 | 224000 | 73 | 114 | 1.34 | |
| 70 | 110 | 54 | 53 | 0.6 | 2 | 114.5 | 42 | 5.5 | 2.5 | E5014 | E5014NR | E5014NRNT | 170000 | 285000 | 78 | 124 | 1.91 | |
| 75 | 115 | 54 | 53 | 0.6 | 2 | 119.5 | 42 | 5.5 | 2.5 | E5015 | E5015NR | E5015NRNT | 177000 | 305000 | 83 | 129 | 2.01 | |
| 80 | 125 | 60 | 59 | 0.6 | 2 | 129.5 | 48 | 5.5 | 2.5 | E5016 | E5016NR | E5016NRNT | 250000 | 430000 | 88 | 139 | 2.71 | |
| 85 | 130 | 60 | 59 | 0.6 | 2 | 134.5 | 48 | 5.5 | 2.5 | E5017 | E5017NR | E5017NRNT | 255000 | 445000 | 93 | 144 | 2.85 | |
| 90 | 140 | 67 | 66 | 0.6 | 2.5 | 145.4 | 54 | 6 | 2.5 | E5018 | E5018NR | E5018NRNT | 305000 | 540000 | 100 | 156 | 3.81 | |
| 95 | 145 | 67 | 66 | 0.6 | 2.5 | 150.4 | 54 | 6 | 2.5 | E5019 | E5019NR | E5019NRNT | 310000 | 560000 | 105 | 161 | 3.97 | |
| 100 | 150 | 67 | 66 | 0.6 | 2.5 | 155.4 | 54 | 6 | 2.5 | E5020 | E5020NR | E5020NRNT | 315000 | 585000 | 110 | 165 | 4.14 | |
| 110 | 170 | 80 | 79 | 1 | 3 | 175.4 | 65 | 7 | 2.5 | E5022 | E5022NR | E5022NRNT | 380000 | 695000 | 122 | 186 | 6.69 | |
| 120 | 180 | 80 | 79 | 1 | 3 | 188.4 | 65 | 7 | 3 | E5024 | E5024NR | E5024NRNT | 400000 | 750000 | 132 | 198 | 7.24 | |
| 130 | 200 | 95 | 94 | 1 | 3 | 208.4 | 77 | 8.5 | 3 | E5026 | E5026NR | E5026NRNT | 535000 | 1000000 | 142 | 218 | 10.9 | |
| 140 | 210 | 95 | 94 | 1 | 3 | 218.4 | 77 | 8.5 | 3 | E5028 | E5028NR | E5028NRNT | 540000 | 1070000 | 152 | 228 | 11.9 | |
| 150 | 225 | 100 | 99 | 1 | 3.5 | 233.4 | 81 | 9 | 3 | E5030 | E5030NR | E5030NRNT | 620000 | 1210000 | 164 | 243 | 14.0 | |
| 160 | 240 | 109 | 108 | 1.5 | 3.5 | 248.4 | 89 | 9.5 | 3 | E5032 | E5032NR | E5032NRNT | 715000 | 1390000 | 174 | 258 | 17.1 | |
| 170 | 260 | 122 | 121 | 1.5 | 3.5 | 270 | 99 | 11 | 4 | E5034 | E5034NR | E5034NRNT | 850000 | 1730000 | 184 | 283 | 23.6 | |
| 180 | 280 | 136 | 135 | 1.5 | 3.5 | 294 | 110 | 12.5 | 5 | E5036 | E5036NR | E5036NRNT | 1060000 | 2140000 | 194 | 311 | 31.7 | |
| 190 | 290 | 136 | 135 | 1.5 | 3.5 | 306 | 110 | 12.5 | 5 | E5038 | E5038NR | E5038NRNT | 1110000 | 2230000 | 204 | 323 | 32.8 | |
| 200 | 310 | 150 | 149 | 1.5 | 3.5 | 326 | 120 | 14.5 | 5 | E5040 | E5040NR | E5040NRNT | 1300000 | 2650000 | 214 | 343 | 42.2 | |
| 220 | 340 | 160 | 159 | 1.5 | 4 | 356 | 130 | 14.5 | 6 | E5044 | E5044NR | E5044NRNT | 1300000 | 3100000 | 236 | 378 | 54.9 | |
| 240 | 360 | 160 | 159 | 1.5 | 4 | 376 | 130 | 14.5 | 6 | E5048 | E5048NR | E5048NRNT | 1560000 | 3350000 | 256 | 398 | 58.7 | |
| 260 | 400 | 190 | 189 | 2 | 5 | 416 | 154 | 17.5 | 6 | E5052 | E5052NR | E5052NRNT | 2110000 | 4500000 | 280 | 438 | 88.1 | |
| 280 | 420 | 190 | 189 | 2 | 5 | 440 | 154 | 17.5 | 7 | E5056 | E5056NR | E5056NRNT | 2200000 | 4850000 | 300 | 462 | 93.9 | |
| 300 | 460 | 218 | 216 | 2 | 5 | 480 | 176 | 20 | 8 | E5060 | — | — | 2650000 | 5850000 | 320 | 508 | 134 | |
| 320 | 480 | 218 | 216 | 2 | 5 | 500 | 176 | 20 | 8 | E5064 | — | — | 2680000 | 6150000 | 340 | 528 | 145 | |
| 340 | 520 | 243 | 241 | 2.5 | 6 | 544 | 194 | 23.5 | 8 | E5068 | — | — | 3350000 | 7550000 | 362 | 577 | 180 | |

Remark: The bearings must be mounted without a clearance between two separate inner rings.

Sheave Bearings
Series 5000

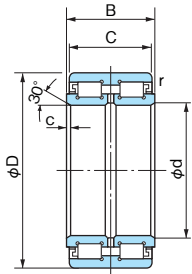

Shield type (E50)

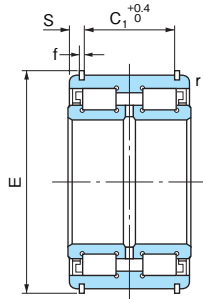

Shield type (E50...NR) with snap rings

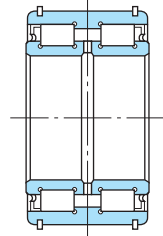

Rubber seal type (E50...NRNT) with snap rings

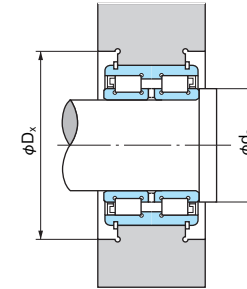

1N=0.102kgf

| Boundary dimensions (mm) | | | | | | | | | | Bearing No. | | | Basic load rating | | Limiting speed (min ⁻¹) Grease lubrication | Abutment and fillet dimensions (mm) | | Mass (kg) |
|--------------------------|-----|-----|-----|---------|---|-----|----------------|------|----|--------------------------------|------------------------------|----------------------------------|-------------------|----------|---|-------------------------------------|----------------------|-----------|
| d | D | B | C | r (min) | c | E | C ₁ | S | f | Without snap ring with shields | With snap rings with shields | With snap rings and rubber seals | Cr (N) | Cor (N) | | d _a (min) | D _x (min) | |
| 360 | 540 | 243 | 241 | 2.5 | 6 | 564 | 194 | 23.5 | 10 | E5072 | — | — | 3400000 | 7950000 | 250 | 382 | 597 | 190 |
| 380 | 560 | 243 | 241 | 2.5 | 6 | 584 | 194 | 23.5 | 10 | E5076 | — | — | 3550000 | 8300000 | 250 | 402 | 617 | 200 |
| 400 | 600 | 272 | 270 | 2.5 | 6 | 630 | 210 | 30 | 12 | E5080 | — | — | 4220000 | 10100000 | 250 | 422 | 666 | 265 |
| 420 | 620 | 272 | 270 | 2.5 | 6 | 650 | 210 | 30 | 12 | E5084 | — | — | 4350000 | 10500000 | 230 | 442 | 686 | 275 |
| 440 | 650 | 280 | 278 | 3 | 8 | 680 | 210 | 34 | 12 | E5088 | — | — | 4550000 | 10900000 | 220 | 464 | 719 | 310 |
| 460 | 680 | 300 | 298 | 3 | 8 | 710 | 230 | 34 | 12 | E5092 | — | — | 5050000 | 12100000 | 200 | 484 | 749 | 365 |
| 480 | 700 | 300 | 298 | 3 | 8 | 730 | 230 | 34 | 12 | E5096 | — | — | 5150000 | 12500000 | 200 | 504 | 769 | 380 |

Remark: The bearings must be mounted without a clearance between two separate inner rings.

Sheave Bearings
Series 4800/4900

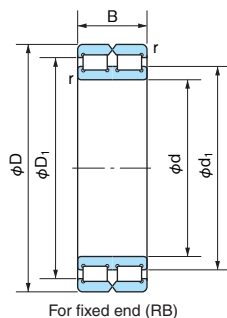

For fixed end (RB)

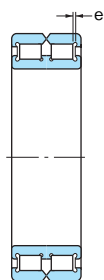

For free end (RC)

1N=0.102kgf

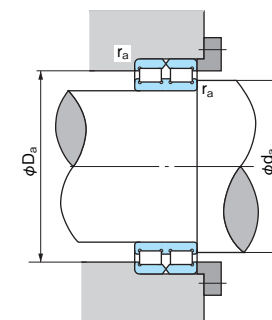

| Boundary dimensions (mm) | | | | | | | Bearing No. | | Basic load rating | | Limiting speed (min ⁻¹) | | Abutment and fillet dimensions (mm) | | | Mass (kg) | Basic No. |
|--------------------------|-----|-----|----------------|----------------|---------|-------|---------------|--------------|-------------------|---------|-------------------------------------|-----------------|-------------------------------------|----------------------|----------------------|-----------|-----------|
| d | D | B | d ₁ | D ₁ | r (min) | e (1) | For fixed end | For free end | Cr (N) | Cor (N) | Grease lubrication | Oil lubrication | d _a (min) | D _a (max) | r _a (max) | | |
| 50 | 72 | 22 | 58 | 63.5 | 0.6 | 1 | RB4910 | RC4910 | 49000 | 83000 | 2000 | 4000 | 56 | 66 | 0.6 | 0.30 | 4910 |
| 60 | 85 | 25 | 69.5 | 76 | 1 | 1 | RB4912 | RC4912 | 68000 | 118000 | 1700 | 3400 | 67 | 78 | 1 | 0.46 | 4912 |
| 70 | 100 | 30 | 81.5 | 88.5 | 1 | 1 | RB4914 | RC4914 | 105000 | 193000 | 1400 | 2800 | 77 | 93 | 1 | 0.79 | 4914 |
| 80 | 110 | 30 | 92.5 | 99.5 | 1 | 1 | RB4916 | RC4916 | 113000 | 221000 | 1250 | 2500 | 87 | 103 | 1 | 0.88 | 4916 |
| 90 | 125 | 35 | 103 | 111.5 | 1.1 | 1 | RB4918 | RC4918 | 150000 | 300000 | 1100 | 2200 | 98 | 117 | 1 | 1.37 | 4918 |
| 100 | 140 | 40 | 116 | 125.5 | 1.1 | 1.5 | RB4920 | RC4920 | 194000 | 400000 | 1000 | 2000 | 108 | 132 | 1 | 2.01 | 4920 |
| 110 | 150 | 40 | 124.5 | 134 | 1.1 | 1.5 | RB4922 | RC4922 | 202000 | 430000 | 900 | 1800 | 118 | 142 | 1 | 2.18 | 4922 |
| 120 | 165 | 45 | 138.5 | 148.5 | 1.1 | 2 | RB4924 | RC4924 | 226000 | 560000 | 850 | 1700 | 128 | 157 | 1 | 2.98 | 4924 |
| 130 | 180 | 50 | 148.5 | 160.5 | 1.5 | 2 | RB4926 | RC4926 | 262000 | 555000 | 750 | 1500 | 140 | 170 | 1.5 | 3.97 | 4926 |
| 140 | 190 | 50 | 159 | 171 | 1.5 | 2 | RB4928 | RC4928 | 271000 | 595000 | 700 | 1400 | 150 | 180 | 1.5 | 4.26 | 4928 |
| 150 | 190 | 40 | 164.5 | 173.5 | 1.1 | 1.5 | RB4830 | RC4830 | 233000 | 575000 | 650 | 1300 | 158 | 182 | 1 | 2.90 | 4830 |
| | 210 | 60 | 171.5 | 186 | 2 | 2 | RB4930 | RC4930 | 405000 | 860000 | 650 | 1300 | 161 | 199 | 2 | 6.70 | 4930 |
| 160 | 200 | 40 | 176 | 185.5 | 1.1 | 1.5 | RB4832 | RC4832 | 242000 | 615000 | 650 | 1300 | 168 | 192 | 1 | 3.05 | 4832 |
| | 220 | 60 | 184.5 | 199.5 | 2 | 2 | RB4932 | RC4932 | 425000 | 935000 | 600 | 1200 | 171 | 209 | 2 | 7.03 | 4932 |
| 170 | 215 | 45 | 186 | 196.5 | 1.1 | 2 | RB4834 | RC4834 | 264000 | 650000 | 600 | 1200 | 178 | 207 | 1 | 4.10 | 4834 |
| | 230 | 60 | 193.5 | 208.5 | 2 | 2 | RB4934 | RC4934 | 435000 | 980000 | 600 | 1200 | 181 | 219 | 2 | 7.44 | 4934 |
| 180 | 225 | 45 | 199 | 209.5 | 1.1 | 2 | RB4836 | RC4836 | 273000 | 695000 | 550 | 1100 | 188 | 217 | 1 | 4.30 | 4836 |
| | 250 | 69 | 205.5 | 223 | 2 | 2.5 | RB4936 | RC4936 | 550000 | 1230000 | 550 | 1100 | 191 | 239 | 2 | 11.0 | 4936 |
| 190 | 240 | 50 | 208 | 220 | 1.5 | 2 | RB4838 | RC4838 | 315000 | 785000 | 550 | 1100 | 200 | 230 | 1.5 | 5.65 | 4838 |
| | 260 | 69 | 216 | 233 | 2 | 2.5 | RB4938 | RC4938 | 565000 | 1290000 | 500 | 1000 | 201 | 249 | 2 | 11.5 | 4938 |
| 200 | 250 | 50 | 218.5 | 230.5 | 1.5 | 2 | RB4840 | RC4840 | 320000 | 825000 | 500 | 1000 | 210 | 240 | 1.5 | 5.90 | 4840 |
| | 280 | 80 | 231.5 | 251 | 2.1 | 3 | RB4940 | RC4940 | 665000 | 1500000 | 500 | 1000 | 211 | 269 | 2 | 15.7 | 4940 |
| 220 | 270 | 50 | 239.5 | 251.5 | 1.5 | 2 | RB4844 | RC4844 | 335000 | 905000 | 450 | 900 | 230 | 260 | 1.5 | 6.40 | 4844 |
| | 300 | 80 | 249 | 268 | 2.1 | 3 | RB4944 | RC4944 | 695000 | 1620000 | 450 | 900 | 231 | 289 | 2 | 17.1 | 4944 |
| 240 | 300 | 60 | 260.5 | 275 | 2 | 2 | RB4848 | RC4848 | 510000 | 1330000 | 400 | 800 | 251 | 289 | 2 | 10.2 | 4848 |
| | 320 | 80 | 271.5 | 291 | 2.1 | 3 | RB4948 | RC4948 | 725000 | 1770000 | 400 | 800 | 253 | 307 | 2 | 18.4 | 4948 |
| 260 | 320 | 60 | 283 | 297.5 | 2 | 2 | RB4852 | RC4852 | 530000 | 1450000 | 400 | 800 | 271 | 309 | 2 | 11.0 | 4852 |
| | 360 | 100 | 296 | 321 | 2.1 | 3 | RB4952 | RC4952 | 1070000 | 2570000 | 350 | 700 | 273 | 347 | 2 | 32.0 | 4952 |
| 280 | 350 | 69 | 307.5 | 325 | 2 | 2.5 | RB4856 | RC4856 | 680000 | 1860000 | 350 | 700 | 291 | 339 | 2 | 16.0 | 4856 |
| | 380 | 100 | 318 | 342.5 | 2.1 | 3 | RB4956 | RC4956 | 1110000 | 2780000 | 350 | 700 | 293 | 367 | 2 | 33.9 | 4956 |
| 300 | 380 | 80 | 329 | 348 | 2.1 | 3 | RB4860 | RC4860 | 800000 | 2160000 | 350 | 700 | 313 | 367 | 2 | 23.0 | 4860 |
| | 320 | 400 | 352 | 371 | 2.1 | 3 | RB4864 | RC4864 | 830000 | 2310000 | 300 | 600 | 333 | 387 | 2 | 24.3 | 4864 |
| 340 | 420 | 80 | 368 | 389 | 2.1 | 3 | RB4868 | RC4868 | 850000 | 2430000 | 300 | 600 | 353 | 407 | 2 | 25.6 | 4868 |
| | 360 | 440 | 392 | 411.5 | 2.1 | 3 | RB4872 | RC4872 | 880000 | 2580000 | 250 | 500 | 373 | 427 | 2 | 27.0 | 4872 |
| 380 | 480 | 100 | 419 | 446 | 2.1 | 3 | RB4876 | RC4876 | 1290000 | 3600000 | 250 | 500 | 393 | 467 | 2 | 45.3 | 4876 |

Note (1): Axial permissible movement for free end bearing.

Remark: The bearings must be mounted without a clearance between two separate inner rings.