

High-speed Angular Contact Ball Bearings

BNH Series

Contact angle=15°

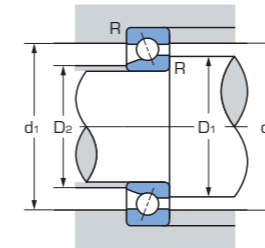
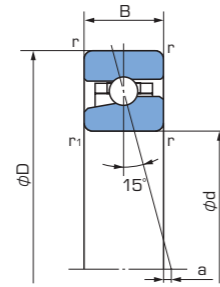

Single-row or tandem

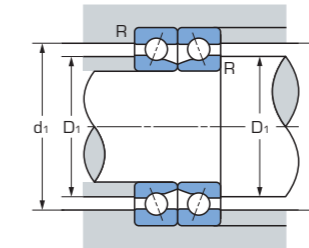

Back-to-back

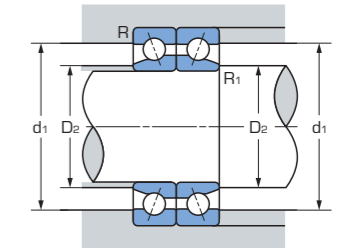

Face-to-face

Bearing No.	Boundary dimensions (mm)					Load center a (mm)	Basic dynamic load rating Cr (kN)	Basic static load rating Cor (kN)	Limiting speed (min ⁻¹)		Corner radius (mm)					Mass (kg) (Reference)	Bearing No.
	d	D	B	r _{min}	r _{1 min}				Grease lubrication	Oil lubrication	D _{1 min}	D _{2 min}	d _{1 max}	R _{max}	R _{1 max}		
BNH007	35	62	14	1	0.6	-0.5	11.6	9.95	28,900	39,000	40	39	57	1	0.6	0.167	BNH007
BNH008	40	68	15	1	0.6	-0.3	14.8	12.9	26,000	35,000	45	44	63	1	0.6	0.200	BNH008
BNH009	45	75	16	1	0.6	0	15.5	14.5	23,400	31,500	50	49.5	70	1	0.6	0.260	BNH009
BNH010	50	80	16	1	0.6	0.7	16.1	15.9	21,600	29,200	55	54.5	75	1	0.6	0.280	BNH010
BNH011	55	90	18	1.1	0.6	0.7	20.0	20.1	19,400	26,200	61	59.5	84	1	0.6	0.400	BNH011
BNH012	60	95	18	1.1	0.6	1.4	20.8	21.9	18,100	24,500	66	64.5	89	1	0.6	0.433	BNH012
BNH013	65	100	18	1.1	0.6	2.1	21.5	23.4	17,000	23,000	71	69.5	94	1	0.6	0.460	BNH013
BNH014	70	110	20	1.1	0.6	2.1	29.4	31.5	15,600	21,100	76	74.5	104	1	0.6	0.650	BNH014
BNH015	75	115	20	1.1	0.6	2.7	29.8	32.5	14,800	20,000	81	79.5	109	1	0.6	0.690	BNH015
BNH016	80	125	22	1.1	0.6	2.7	35.0	39.0	13,700	18,500	86	84.5	119	1	0.6	0.930	BNH016
BNH017	85	130	22	1.1	0.6	3.4	35.5	40.0	13,100	17,700	91	89.5	124	1	0.6	0.973	BNH017
BNH018	90	140	24	1.5	1	3.4	46.5	53.0	12,200	16,500	97	95.5	133	1.5	1	1.27	BNH018
BNH019	95	145	24	1.5	1	4.1	47.0	55.0	11,700	15,800	102	100.5	138	1.5	1	1.33	BNH019
BNH020	100	150	24	1.5	1	4.7	48.0	56.5	11,200	15,200	107	105.5	143	1.5	1	1.39	BNH020
BNH021	105	160	26	2	1	4.8	54.5	65.0	10,600	14,300	115	110.5	150	2	1	1.77	BNH021
BNH022	110	170	28	2	1	4.8	61.0	74.0	10,000	13,600	120	115.5	160	2	1	2.18	BNH022
BNH024	120	180	28	2	1	6.1	63.0	79.0	9,400	12,700	130	125.5	170	2	1	2.32	BNH024
BNH026	130	200	33	2	1	5.6	83.5	105	8,500	11,500	140	135.5	190	2	1	3.46	BNH026
BNH028	140	210	33	2	1	6.9	86.0	112	8,000	10,900	150	145.5	200	2	1	3.68	BNH028
BNH030	150	225	35	2.1	1.1	7.6	102	132	7,500	10,100	161	156	213	2	1	4.55	BNH030
BNH032	160	240	38	2.1	1.1	7.8	110	145	7,000	9,500	172	166	228	2	1	5.57	BNH032
BNH034	170	260	42	2.1	1.1	7.8	129	173	6,500	8,800	182	176	248	2	1	7.50	BNH034